

UNISPACER™ CENTRALIZER

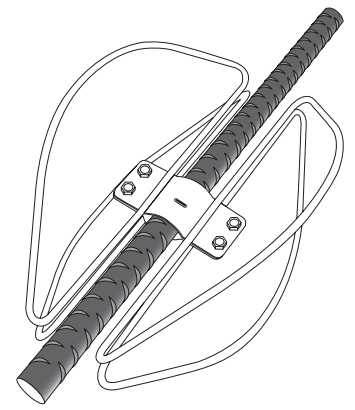

ANOTHER PRACTICAL ENGINEERED CONCEPT FROM

LOWTECH CORPORATION

Patents Pending

UNISPACER a guide and alignment system for single bar reinforcement positioning within Auger-Cast Piles, mini-piles, micro-piles, soil anchors, tie backs, and other geotechnical construction applications

APPLICATIONS

- Auger-cast pile foundations
- Shell pile foundations
- Drilled pile foundations
- Soil Anchors
- Tiebacks
- Mini-pile foundations
- Micro-pile foundations
- Shear Keys



ADVANTAGES

- Saves time and money
- Easily Installed
- Practically Engineered
- Readily stacks for shipping
- Reduced freight costs (stacking)
- Saves room on project jobsites (stacking)
- Strong and durable
- Provides an excellent guide system for placement of single bars into structural foundation shafts
- Economical to use
- Single bars are properly positioned and centralized within a single shaft diameter prior to or after concrete or grout placement.

CONSTRUCTION BENEFITS

- Insures that the bar reinforcement is properly spaced and aligned within the confines of the shaft or pile structure
- Provides built-in quality control for the engineer
- Increased job profitability due to quick and easy installation
- Requires only unskilled labor to install
- Skilled labor is released for more demanding tasks
- Low labor requirements result in ultimate project cost savings

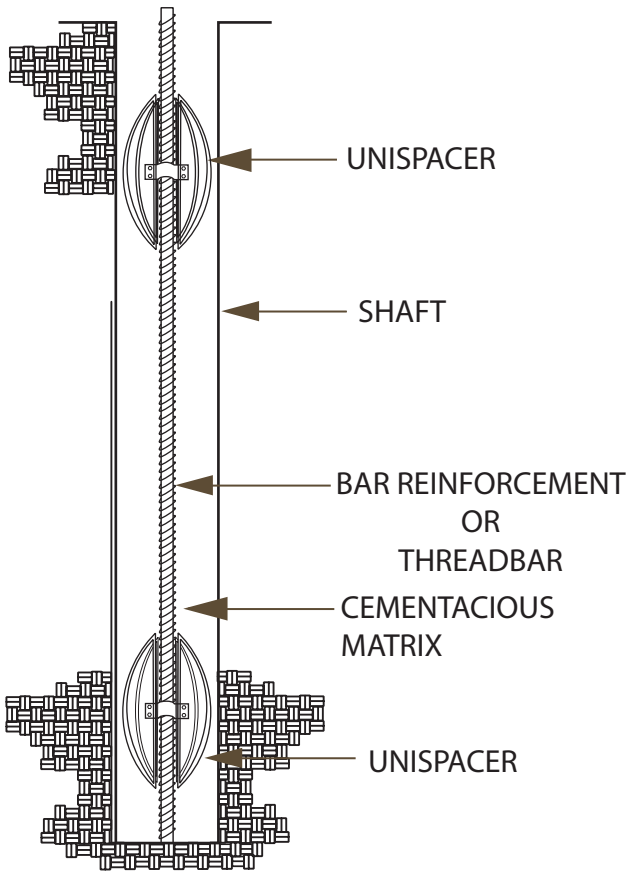

SHAFT ELEVATION
NO SCALE

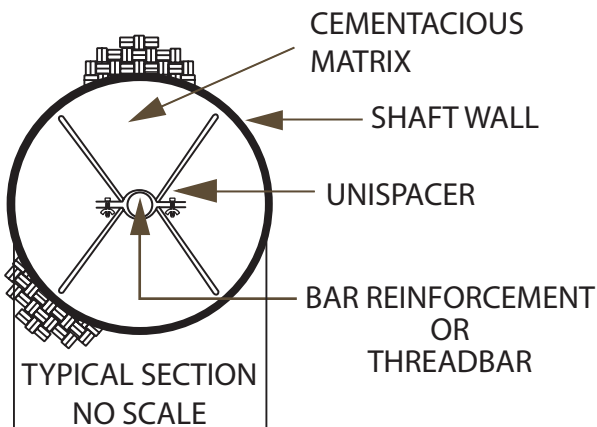

TYPICAL SECTION
NO SCALE

Members:



SAMPLE SPECIFICATIONS:

The bar reinforcement shall be concentrically spaced and supported inside the shaft and held securely in position within the specified tolerances. Utilize bar centralizing devices for positioning bar reinforcement the length of the shaft. Provide spacers or centering devices such as the **UNISPACER™** centralizer (manufactured and distributed by Foundation Technologies, Inc., Lawrenceville, Georgia Phone 1.800.773.2368) or an approved equal.

OR

The bar reinforcement shall be concentrically spaced and supported inside the shaft and held securely in position within specified tolerances. Utilize bar centralizing devices for positioning bar reinforcement the length of the shaft. An approved method of spacing and centralization of bar reinforcement within the shaft is the **UNISPACER™** centralizer manufactured and distributed by Foundation Technologies, Inc., Lawrenceville, Georgia Phone 1.800.773.2368.

UNISPACER MINIMUM PLACEMENT RECOMMENDATIONS:

Place lower centralizer 24 inches from the end of the bar from the shaft bottom. Space additional centralizers a maximum of 15 feet along the length of bar to be centered from the lower most centralizer. Each shaft should contain a minimum of 2 centralizers per bar installed. The top most centralizer should be positioned within 2 to 4 feet from the top of the shaft.

UNISPACER™ Centralizers are currently available in three models:

- Model US1618 for 16 to 18" diameter shafts
- Model US1214 for 12 to 14" diameter shafts
- Model US0600 for 6" diameter shafts

UNISPACER™ Centralizers provide for universal fitting of bar sizes from #7 bar (or #22 metric) to #11 bar (or #36 metric) reinforcement.

UNISPACER™ Centralizers also provide universal fitting of threadbars from 0.875-in. diameter to 1.5-in. diameters.

UNISPACER™ Centralizers are available plain or plated as required. Specialty sizes and coatings can be provided with sufficient lead-time allowance.

UNISPACER™

Manufactured and Marketed by:

Foundation Technologies, Inc.®

PO Box 491718 Lawrenceville, GA 30049

800.773.2368 Fax: 678.407.4645

www.foundationtechnologies.com

info@foundationtechnologies.com